

## Shipping your Left crank arm to 4iiii Innovations for Installation of a Precision (Left Side) Powermeter

These instructions will guide you in preparing your Left Crank Arm for shipment to 4iiii.

- Clean your Crankset while its on your bike.
- Use a AAA battery to check the clearance between your existing left crank arm and your bike. The battery is 10mm thick. **Precision is 8mm thick.**
- As you locate the flat installation surface on the left crank arm, simply slide the battery along the crank. If there are areas where the AAA battery does not have clearance, note the places where the battery touches either side and mask the areas with a light adhesive masking tape, such as painter's tape. Do not use duct tape, labels, or double sided tape.
- Take a picture of your frame and left crank to show the clearance. Include the AAA battery to provide reference.
- Email the picture to [sales@4iiii.com](mailto:sales@4iiii.com), and include your bike frame model.
- Remove your left crank arm from your bike according to your crank manufacturer's instructions.

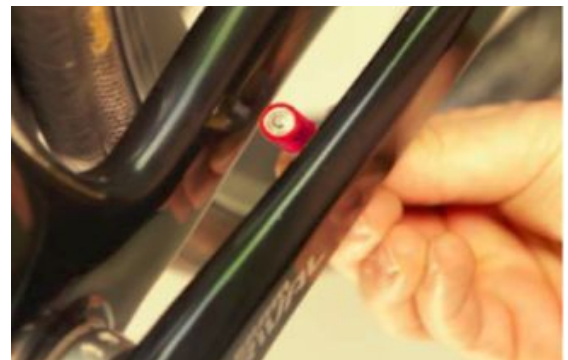
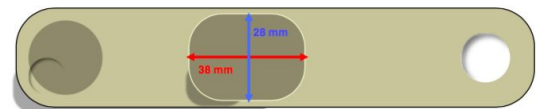

### Need additional help?

Contact us at 1-800-218-3095 and ask for Customer Support  
Or send us an email at [support@4iiii.com](mailto:support@4iiii.com)

Crank Preparation Continued:

- For Shimano, please remove the bolt and clips from the crank.
- For Cannondale Cranks, please remove and keep the crank arm fixing bolt.
- For SRAM GXP crank, please leave the crank arm fixing both retaining bolts installed on the crank arm.

Shipping:

- You will receive an email from Fedex with your shipping label. Please print off all shipping documents, by following their links.
- Take your shipping documents along with your crank arm, down to your nearest Fedex shipping centre, and ship to us.
- Fedex will provide a box or a pad pack for your shipment, and will help you complete your necessary paperwork.
- If you choose to use a pad pack, please wrap the crank arms in bubble wrap first before using the Pad Pak.
- If you choose to ship this in a box, please do not use a box larger than 27cm X 22cm X 21cm.
- Please click [here](#) for general video instructions on preparing your crank arm for shipping.



- Here's a breakdown of how long it may take you to receive your crank arm with your Powermeter installed.
  - You will ship us your crank arm - Shipping time may vary depending on where you are located.
  - **We will install your Powermeter (Estimated installation time is 5-8 business days).**
  - Once your installation is complete, we will ship your unit back to you, and provide you with a tracking number so you can track the package on its way back to you.
  - **Note, shipping times may also vary based on the shipping option you selected when completing your order.**

**Need additional help?**

Contact us at **1-800-218-3095** and ask for Customer Support  
Or send us an email at [support@4iiii.com](mailto:support@4iiii.com)